

# Specifically for handling radioactive substances

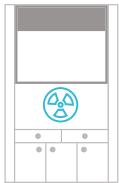

So you can work safely: Radionuclide fume cupboards protect against radiation and substance escape and are easy to decontaminate. For extremely stringent requirements, a fully welded stainless steel interior with few seams can be installed.



- ✓ Design and construction compliant with DIN 25466
- ✓ Sash with access openings
- ✓ Stainless steel worktop
- ✓ Low air volume flow possible
  - Load capacity of more than 1.5 t allows the addition of lead shielding
  - Optional lead lining under worktop



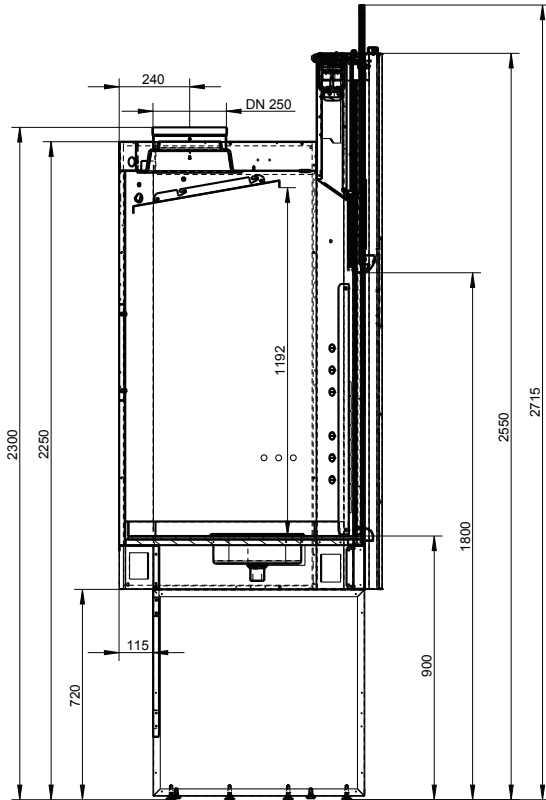

Width	1200	1500
Front height	2550	2550
Chamber height	2300	2300
Depth	900	900
Usable space width	1100	1400
Usable space height	1190	1190
Usable space depth	800	800
Work height	900	900
Minimal permissible volume flow rate**	450	720
Specified volume flow rate	500	800
Maximum permissible volume flow rate	1500	1500

Dimensions [mm] / Volume flow rate [m<sup>3</sup>/h]

\*\* Alarm value

# Radionuclide fume cupboard



	Suitable	Occasional use	Not suitable
Organic solvents	x		
Weak acids	x		
Diluted inorganic acids	x		
Cold concentrated inorganic acids		x	
Hot concentrated inorganic acids		x	
Hydrofluoric acid		x	
Radioactive substances	x		
High thermal load		x	

When selecting a fume cupboard, the most important considerations are the activities you do and the substances you use.